

Products for Indoor Use	
Ideas for your event	4-5
Counter/Transport Box:	
Expand PodiumCase	6-7
Expand PodiumCase XL	8
Large Displays/Pop-Ups	
Expand 2000	10
Expand MediaWall	11
Expand MediaWall XL	12
Expand MediaFabric	13
Expand GrandFabric	14-15
Expand Tower	16
Flexible Display System	
Expand LinkWall	17-19
Carpets & Mats	20
Monitor Holders	
Expand MonitorStand XL	21
Retractable Displays/Roll-Ups	
Expand MediaScreen 1	23
Expand MediaScreen 2	24
Expand QuickScreen 3	25
Expand M2	26
Expand PromoRollup	27
Expand MediaScreen XL	28-29
Non-Retractable Banners	
Expand BannerStand	31
Expand SmartStand	32
Expand XStand	33
Brochure Stands	
Expand BrochureStand	34
Expand BrochureHolder	34
Spotlights	35
Products for Outdoor Use	
Expand FlagStand XL	37
Expand FlagStand 1	38
Expand MediaScreen 2 outdoor	39
Expand DisplayTunnel	40
Expand VenueTent	41
Artwork & Free 3D Rendering Tool	42

Get inspired with these displays for your event



High Visual Impact

Combine a gigantic pop up wall with digital signage

This extra large pop up (Expand MediaWall XL) is 181 1/8" (460 cm) wide and 103 15/16" (264 cm) tall. This kit also includes an Expand BrochureStand for your catalogs, handouts and literature. The Expand MonitorStand XL holds a large flat screen to show a digital presentation or movie. Add a carpet with logo or full color graphic: to create the perfect setting for your customers.

Expand PodiumCase

Pack your Expand MediaWall XL in the Expand PodiumCase, our transport case on wheels that easily converts into a spacious counter. All other products shown above are delivered in nylon carry bags.



Expand Grande



Expand DoubleDesk



Expand Presenter



Expand 360



Expand MultiMedia



Quick Impact Display

A stand that is super fast to set up

Time is money, and this kit enables you to assemble an entire display set up in a few minutes. The counter is the shipping case, and its wheels make transport simple. The two retractable displays (Expand MediaScreen 1) need 30 seconds each to set up, and the large fabric backdrop (Expand MediaFabric) can easily set up in a minute. Pack brochures in the Expand BrochureStand prior to the event, and then just set it up on location.



Expand PodiumCase

A transport case that can be turned into a counter

To create the counter, just open the case, add the preferred table top, the case skirting and a branded graphic wrap. This simple conversion becomes a smart focal point at any event.



Expand PodiumCase is perfect for transporting our large display walls and most of our other products.

The Expand PodiumCase fits into most vehicles.





Inside, there are detachable shelves to hold brochures, demo products and drinks out of sight from guests.



It can also be used closed as a smaller table. Tops are available in oak, birch, aluminium, black and white.



Wooden table tops are available in oak, birch, aluminium, black, white and black plastic. The black plastic version is a light-weight table top that also can be used outdoors.

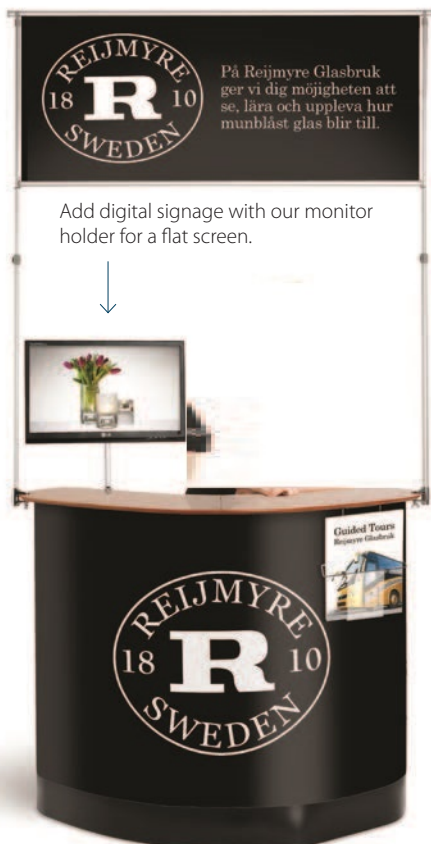

Use our graphic holder, the **Expand Header** to create a kiosk.

Add digital signage with our monitor holder for a flat screen.

Add the **Expand BrochurePocket** for brochures.



Closed Sizes:
 Width: 25 9/16" (65 cm)
 Height: 39" (99 cm)
 Depth: 17 1/8" (43.5 cm)

Open Sizes:
 Width: 48 7/16" (123 cm)
 Height: 39" (99 cm)
 Depth: 24" (61 cm)

Weight:
 22 lbs. (10 kg)

Accessories:

Shelves, table top, monitor holder, Expand Header, Expand BrochurePocket

Expand PodiumCase XL

Two transport cases that can be turned into a larger counter

To create this XL counter, open the cases, and attach the wooden top. Next, add the base skirting and a large branded graphic wrap for a greeting or service area for any event.



Display products on a wooden, black top that comes in two bags.



Inside, there are detachable shelves to hold your brochures, demo products and drinks out of sight from guests.

Open Sizes:
 Width: 85 13/16" (218 cm)
 Height: 38 9/16" (98 cm)
 Depth: 41 3/4" (106 cm)

Weight:
 44 lbs. (20 kg)

Accessories:
 Shelves, table top, monitor holder, Expand Header, Expand BrochurePocket

Large Displays/Pop-Ups

To create extra impact, a large display is the perfect choice. With our pop-up walls a large image sets up quickly and easily.

- Large displays create extra impact
- Impressive size with quick and easy installation
- Comes in transport case or bag with wheels for easy transportation





Expand 2000

Pop-up system with endless possibilities

The Expand 2000 is one of the most flexible display systems on the market today. This wall mural is available in standard straight and/or curved sizes. This unit can easily be linked to create custom configurations and shapes.



L-Shape



S-Shape



U-Shape



Add a showcase to promote your products.

Sizes:

Width: Flexible

Height: 60", 88 9/16", 118 1/8" (152, 225, 300 cm)

Accessories:

Spotlights, shelves, showcases, monitor holders,
Expand PodiumCase



Expand PodiumCase

Pack a complete Expand MediaWall in the Expand PodiumCase with wheels for easy shipping and transport.



Nylon bag

A pop-up mural can also be stored and transported in a nylon bag with wheels (sizes 1x3–4x3).

Expand MediaWall

Our most popular pop-up wall

The Expand MediaWall has the perfect curve to maximize the visibility of your message. Despite its size, it is quick and easy to set up. This system is one of the lightest pop-up walls on the market. It is available in five different widths to fit different locations and meet various needs. Use this mural system for events, exhibitions, or as a perfect backdrop for press conferences. The Expand MediaWall is also available in a straight version.

Curved Sizes & Weights



1x3

Width: 49 3/8" (125 cm)
Height: 90 9/16" (230 cm)
Deep: 13 3/4" (35 cm)

Weight w/bag & graphics:
17 lbs. (7.7 kg)



2x3

Width: 79 15/16" (203 cm)
Height: 90 9/16" (230 cm)
Depth: 20 1/2" (52 cm)

Weight w/bag & graphics:



3x3

Width: 106 5/16" (270 cm)
Height: 90 9/16" (230 cm)
Depth: 22 1/16" (56 cm)

Weight w/bag & graphics:



4x3

Width: 132 11/16" (337 cm)
Height: 90 9/16" (230 cm)
Depth: 28 3/8" (72 cm)

Weight w/bag & graphics:



5x3

Width: 159 7/16" (405 cm)
Height: 90 9/16" (230 cm)
Depth: 39 3/8" (100 cm)

Weight w/bag & graphics:
41 lbs. (18.6 kg)



Expand MediaWall XL

A gigantic pop-up wall

This super sized pop-up wall makes you stand tall among the rest. It is both taller and wider than most traditional pop-up walls. Despite its impressive size, it can be easily set up by one person.

Pack this huge mural in our Expand PodiumCase, a combined transport case and counter that fits in a car. Spotlights are available to enhance the impact of any message.



Expand PodiumCase

Pack your Expand MediaWall XL in the Expand PodiumCase and transport it from your car to your event.

Sizes & Weights



4x3
 Width: 153 9/16" (390 cm)
 Height: 103 15/16" (264 cm)
 Depth: 31 1/2" (80 cm)
 Weight w/graphics:
 45 lbs. (20.4 kg)



5x3
 Width: 181 1/18" (460 cm)
 Height: 103 15/16" (264 cm)
 Depth: 42 1/2" (108 cm)
 Weight w/graphics:
 52.25 lbs. (23.7 kg)



The Expand MediaWall XL offers a 33 percent larger graphic surface than our regular Expand MediaWall.





Expand MediaFabric

A large fabric pop-up wall that you set up in minutes

This branded fabric is printed on a wrinkle-resistant material that fastens to the frame with Velcro®. The image quickly stretches to a smooth surface when you open the frame.

The graphics can easily be cleaned or replaced when needed. Illuminate a message with our halogen or LED spotlights.



This fabric pop-up is also available in a curved version (8' and 10' only)

Sizes:

Width (most common): 30 15/16", 60 3/8", 89 13/16",
119 5/16", & 148 3/4" (79, 153, 228, 303, 378 cm)

Height (most common): 60 3/8", 89 7/8"
(153 and 228 cm)

Accessories:

Spotlights, Expand PodiumCase



Delivered in a nylon bag or the Expand PodiumCase for easy transportation.



Expand GrandFabric

The Expand GrandFabric is a unique combination of portability and ease of set-up that allows the creation of modular like structures. The system comes in 10 standard-sized frames, and all frames are collapsible for ease of transport. The full system can travel in an Expand PodiumCase and takes less than ten minutes to set up.

Sizes & shapes:

Straight and curved shapes (3 different curves) in various widths.
 Heights: 94 1/2" (240 cm) and 125 3/16" (318 cm)



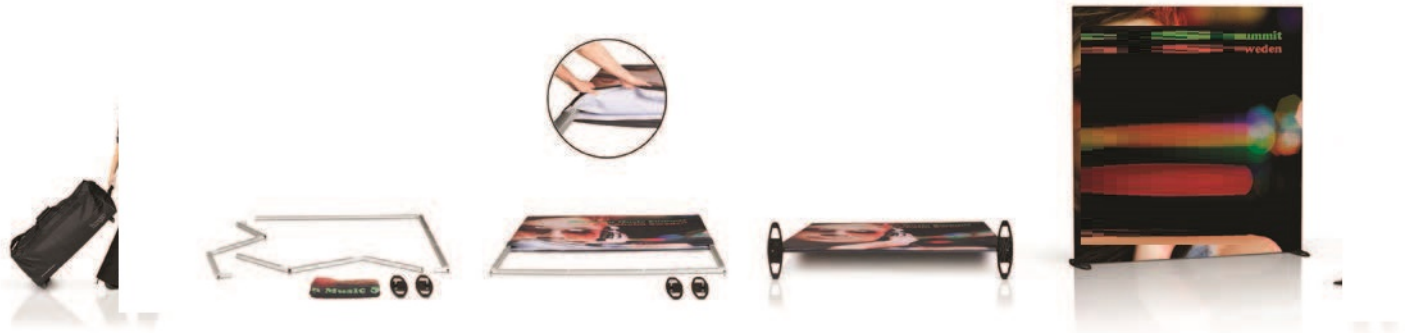

Easy to set up

1. Click the 4 frame parts together
2. Pull the pillow case fabric graphic over the frame
3. Close the zipper
4. Attach the two feet.
5. Ready!

Graphic branding

As the fabric always covers both the front and the back, choose between:

- Different graphic prints on the front and back
- The same graphic print on the front and back
- Graphic print on the front with a black fabric on the back



Easy to transport and store



It is delivered in a bag on a case on wheels that can be



www.bciimage.com

866 971-1008

Expand Tower

The Expand Tower is a highly effective medium for attracting a little extra attention.

On a small floor surface, the circular shape allows for different and creative solutions for messaging and logos.

The Expand Tower comes with a nylon bag for easy storage and transportation.

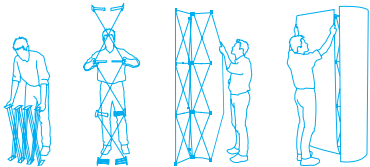

Create a striking eye-catcher by backlighting your Expand Tower.



Sizes:

Diameter: 26" (66 cm)
Height: 88 9/16" (225cm)

Accessories:

Spotlights for external lighting, fluorescent bulbs for internal backlighting

Expand LinkWall

Expand LinkWall allows for ultimate flexibility to meet the needs of any event space. Change the shape by curving the flex panels to fit each location. Change the size by adding or removing flex panels.

This flexible display system uses base units with graphics and flexible graphic panels to connect any unit together with our patented magnetic solution. Our flexible panels have a rubber profile that flexes to change the shape of the display. Combine an infinite amount of graphic and flex panels to create multiple configurations.

Change the shape & size

Expand LinkWall is the perfect investment for any business. It can be used in different configurations for each event. The designs on the right are all made from the same display.

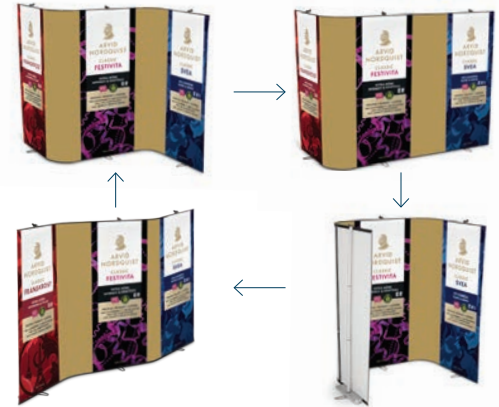

Stand out from the crowd

Have a powerful presence at your next event with the Expand LinkWall in a unique shape. The layout above uses: two integrated monitors, the Expand PodiumCase as a counter, color matching carpet and LED spotlights.

Sizes:

Width: Flexible
 Graphic Height: 86 5/8" & 114 3/16" (220 & 290 cm)
 Product Height: 89 3/4" & 117 5/16" (228 & 298 cm)

Accessories:

Spotlights, Monitor Holder
 (for flat screens up to 8.8 lbs. (4 kg), supports VESA 75 & 100)



The Expand LinkWall system with 7 base units, 6 flexible panels, and 3 end panels can create all the displays below.



U-Shape



Open U-Shape



Star Island



L-Shape



Large C-Shape



Triangular Towers

Perfectly straight walls

Connect different Expand LinkWall base units together to create a perfectly straight wall. Our patented leveling system ensures the display will remain straight, even on an uneven floor. Straight walls can also be single or double-sided. Optional end panels can be used for a clean, three-dimensional look.

Pack it in a bag...

2 Expand LinkWall base units, 1 flexible panel, and spotlights all fit in our custom bag.



End panel
Add end panels for a three-dimensional look.

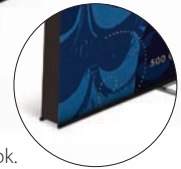

...or in the Expand PodiumCase

The Expand PodiumCase holds 3 Expand LinkWall base units, 2 flexible links, and spotlights. There is enough additional room for the table top, inner shelves, and graphic wrap for the counter.



Carpets and Mats

Beautiful and durable custom dye sublimation floor graphics with branding and images for trade shows, in-store events, entrance, or waiting areas – anywhere you need additional color and message awareness.

A floor graphic enhances any marketing effort by providing additional space for branding, and extending a message at any event. These full color floor graphics are available in different thicknesses and surfaces, depending upon the intended use. We offer short-term use mats, entrance carpets and plush carpets for long-term use in a variety of sizes. These rubber-backed products are non-slip, and can even help reduce fatigue!



Short-term use floor mat



Washable carpet with bound edges.

Entrance carpet with logo and image



Carpets enhance your trade show or event.



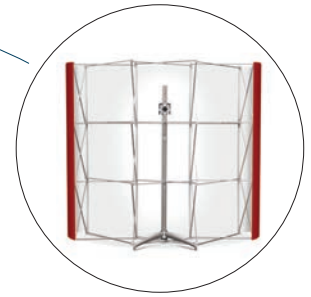
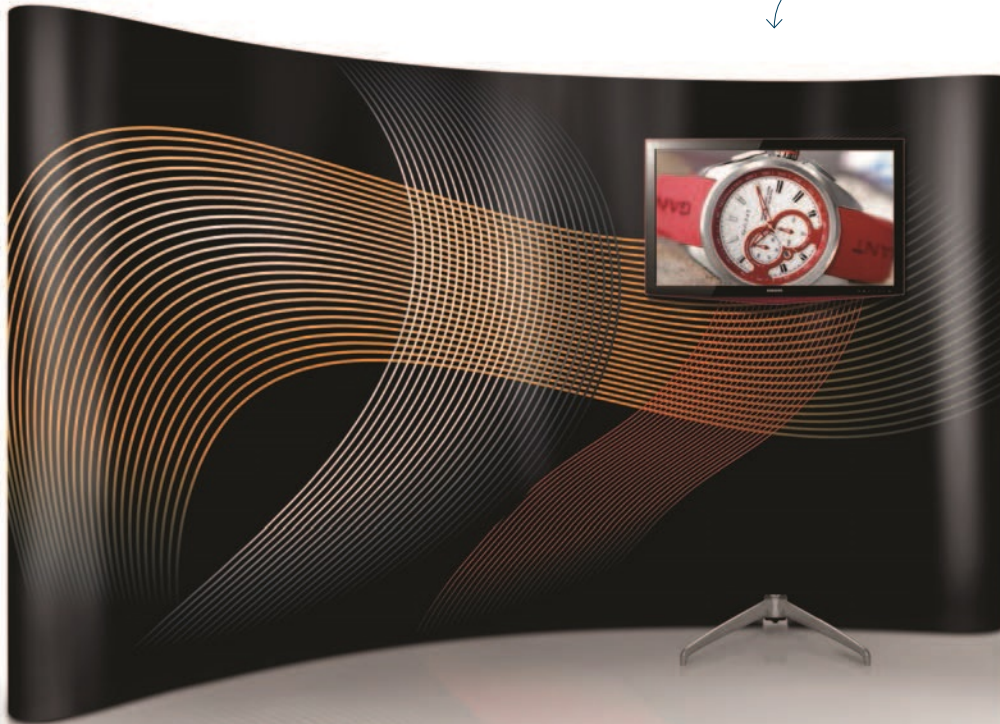

Expand MonitorStand XL

Expand MonitorStand XL is an extra large stand for monitors and flat screens up to 92.6 lbs. (42 kg) or 60". It can be used as a freestanding display or integrated with one of our mural walls (Expand MediaWall, Expand MediaWall XL and Expand LinkWall). When the monitor stand is used with these products, a panel is cut to fit the foot and monitor mount. The stand is very stable, and is delivered in one nylon bag. (Monitor not included)



The extra stable base collapses for easy transport and storage. When ready for set-up, simply flip the base upside down and fold out the legs.

Sizes:

Footprint: 30 5/16" x 30 5/16" (77 x 77 cm)
 Monitor Height *: 63", 66 15/16", 70 7/8" & 74 13/16"
 (160, 170, 180 & 190 cm)

Weight:

44.5 lbs. (20.2 kg) Including Bag

Accessories:

Keyboard/Laptop Shelf



* These heights are for the mounting holes on the vertical pole. Actual monitor height will vary depending on monitor size and mounting location.

Your monitor is mounted using the universal VESA standard 200 x 200 up to 400 x 600.



Sizes:

Width: 33 7/16", 39 3/8" & 59 1/16" (85,100 & 150 cm)
 Adjustable Height: 63" - 88 5/8" (160-225 cm)

Weight:

11-12.8 lbs. (5-5.8 kg) Including Bag

Accessories:

Spotlight, Transport Case, Expand BrochurePocket,
 Profile connector for linking displays together

Expand MediaScreen 1

A cost-effective display with a telescopic pole

With its compact shape and streamlined design, this retractable display fits in most environments. The Expand MediaScreen 1 is equipped with a foldable support foot to ensure stability.

The telescopic pole makes it easy to adjust the image height, and a spotlight is available to illuminate any message.



The 59 1/16" (150 cm) width is perfect as a backdrop for any event. Two of these wide retractables side by side will fit in a 10' space.

Expand MediaScreen 2

Double-sided retractable display

Expand MediaScreen 2 is perfect in environments where people pass by from different directions. Display the same message on both sides or show two separate messages for twice the impact.

Expand MediaScreen 2 is also available for outdoor use, see Expand MediaScreen 2 outdoor on page 39.

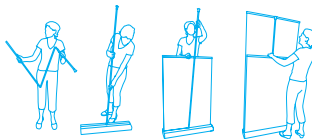

Sizes:

Width: 33 7/16" & 39 3/8" (85 & 100 cm)

Height: 78 3/4" & 86 5/8" (200-220 cm)

Weight:

15.4 lbs. (7 kg) Including Bag

Accessories:

Spotlights, Transport Case, Expand BrochurePocket



Expand QuickScreen 3

Available in seven colors

The Expand QuickScreen 3 has an attractive and unique design that adds an extra dimension of exclusivity, that helps strengthen the impact of a brand's message.

With its ingenious, patented system of changeable cassettes, it is easy for you to change an image on-site in minutes. Use the telescopic pole to easily vary the height of a display.

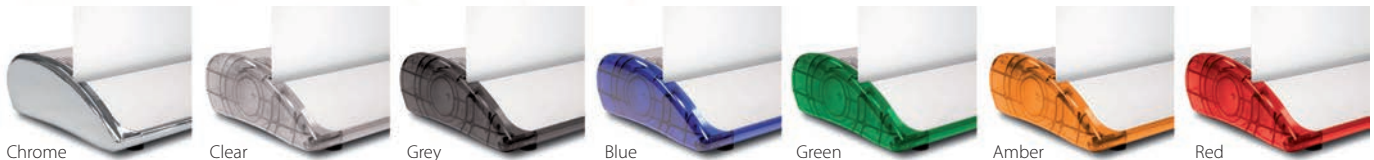
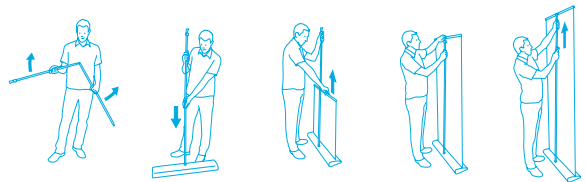

Sizes:

Width: 33 7/16" & 39 3/8" (85 & 100 cm)

Adjustable Height: 63" - 88 5/8" (160-225 cm)

Mini Size: 19 11/16"W x 70 7/8" (50 x 180 cm)

Weight:

8-12 lbs. (3.6-5.5 kg) Including Bag

Accessories:

Spotlight, Transport Case, Expand BrochurePocket



Expand M2

Simple change of graphics

This retractable display ,with its tailored design, is a popular choice when multiple image changes are planned. This is a perfect solution for cost-effective, targeted marketing.

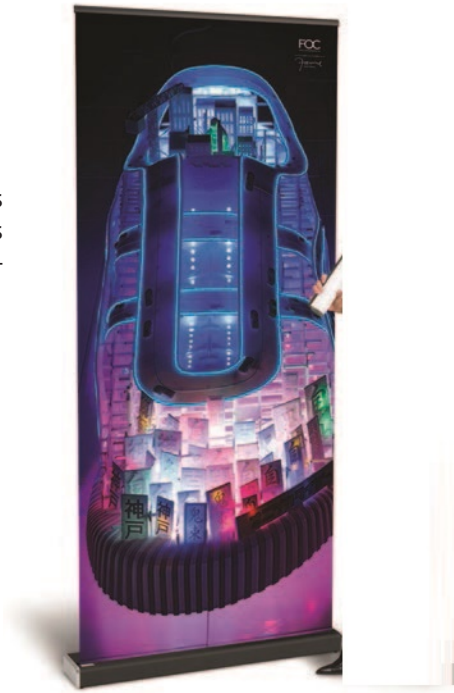

Changing graphics only takes a minute

Just open the unit, take out the graphic roll, and replace it with a new one. It is under no tension when retracted, making it safe and easy.

Your extra graphic is protected in a cardboard tube.

Sizes:

Width: 33 7/16" & 39 3/8" (85 & 100 cm)
Adjustable Height: 63" - 88 5/8" (160-225 cm)

Weight:

13 lbs. (6 kg) Including Bag

Accessories:

Spotlight, Transport Case, Expand BrochurePocket



Black



Silver



Expand PromoRollup

A cost-effective retractable display for large volume requirements.

This retractable display is perfect for specific campaigns like product launches, where you need to relay a message in multiple locations. This unit comes at a cost effective rate that maintains high quality, durability, and functionality.

Sizes:

Width: 33 7/16" (85 cm)

Height: 78 3/4" (200 cm)

Weight: 7.7 lbs. (3.5 kg)



The Expand PromoRollup
retractable display for large volume requirements.

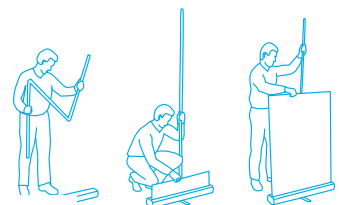

www.bciimage.com

866 971-1008



Expand MediaScreen XL

An extra tall, extra wide retractable display

Expand's patented magnetic connectors in the top profile, allows the combination of two or more Expand MediaScreen XL displays to create an extra large backdrop, without the need for tools or a ladder.

These extra wide roll-ups come in a nylon carry bag. We also offer several different shipping case solutions that make transporting and storing of displays easy.

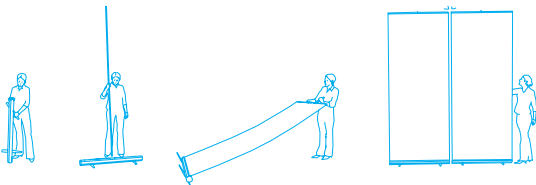

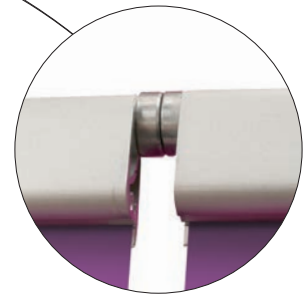

Patented magnetic connectors



Pack Expand MediaScreen XL displays in our transport cases with wheels. This transport case easily converts into a spacious counter.

A large backdrop in minutes

The Expand MediaScreen XL is quick and easy to set up. The patented magnetic connectors allows the joining of several displays with a simple click. Three of these retractable displays (39 3/8" wide) creates a mural that fits into a 10 foot wide space and can reach up to 10 feet high.



It can also be used as an individual

Sizes:

Width: 39 3/8" & 47 1/4" (100 & 120 cm)
 Height: 78 3/4", 85 13/16", 98 3/8" & 118 1/8"
 (200, 218, 250 & 300 cm)

Weight:

14 & 16 lbs. (6.4 & 7.3 kg) Including Bag

Accessories:

Spotlight, Transport Case,
 Expand BrochurePocket



Non-Retractable Displays

Lightweight displays in a variety of sizes and designs

- Foldable pole (does not have a retractable function)
- Set up in minutes - with a few simple steps
- Sleek and smooth for a polished look
- Comes in a bag for easy transport



Expand BannerStand

Lightweight display with a slim design

The Expand BannerStand was designed for those who need a flexible system that can be tailored to suit different needs and requirements.

It is available in 17 different sizes, and can be linked together with our patented magnetic system. This design allows the seamless combination of several banner stands to create one large image.

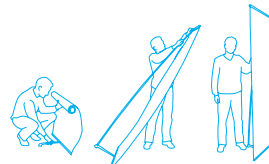

Sizes:

Width: 15 3/4", 23 5/8", 27 9/16", 31 1/2" & 39 3/8"
(40, 60, 70, 80 & 100 cm)

Height: 55 1/8", 70 7/8", 86 5/8" & 98 7/16"
(140, 180, 220 & 250 cm)

Weight:

6-7.5 lbs. (2.8-3.35 kg) Including Bag

Accessories:

Spotlight, Transport Case, Expand BrochurePocket



www.bciimage.com

866 971-1008

Expand SmartStand

Lightweight, double-sided display

Expand SmartStand will lift an image up from the floor. It's telescopic pole makes it easy to change the height, and adapts the size of the image to suit specific needs. The Expand SmartStand is available in four widths.

The Expand SmartStand can be double-sided to display any message from two directions for maximum impact.

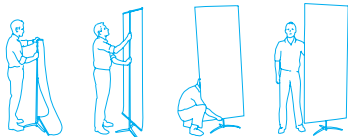

Sizes:

Width: 19 11/16", 23 5/8", 27 9/16" & 31 1/2" (50, 60, 70 & 80 cm)
Adjustable Image Height: 33 7/16" - 82" (160-210 cm)

Weight:

4.5 lbs. (2.1 kg) Including Bag

Accessories:

Spotlight, Transport Case, Expand BrochurePocket

Expand XStand

Economical campaign solution

The Expand XStand is a super-lightweight, non-retractable display. It is the ideal solution for campaigns and product launches.

Create high visibility in multiple locations with this cost effective, marketing display. The Expand XStand combines function, attractive design, and affordability.

This display can be set up in less than a minute without tools.

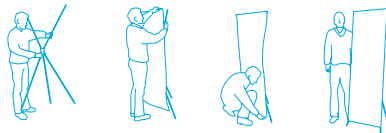

Graphic Sizes:

24 1/2"W x 63 1/2"H, 26 1/2"W x 71"H
& 32 1/2"W x 71"H

Accessories:

Cardboard Shipping Box, Expand BrochurePocket

Expand BrochureStand

A compact and stylish brochure stand

The Expand BrochureStand is a unique, collapsible literature holder that is lightweight, and comes in an easy-to-carry nylon bag. The pockets are spacious, and will take various types of documents up to legal size (8 1/2" W x 14" H).

Made from carefully selected material, and designed with precision to guarantee problem-free usage with a long lifetime. It is offered in a 4 or 5 tray version, and all of the components are completely recyclable.



The stable magnetic locking connector makes it very easy to move when set up.



Load it with brochures even when collapsed.



Sizes:

Width: 10 1/4" (26 cm)

Height: 54 3/4" (140 cm) open / 6 7/8" (17.5 cm) collapsed

Height: 68" (173 cm) open / 8 1/16" (20.5 cm) collapsed

Floor space: 10 1/4" wide x 15 3/4" deep (26 x 40 cm)

Tray space: 8 11/16" wide x 14 3/8" high x 1 1/8" deep (22 x 36.5 x 2.8 cm)

Weight:

9.5 & 10.8 lbs. (4.3 & 4.9 kg) Including Bag

Accessories:

Graphic Holder, Graphic Panel

Expand BrochureHolder

Lightweight brochure stand

This brochure stand is very light and easy to set up. All three versions come in a practical nylon bag.

Sizes:

Width: 9 13/16" & 19 11/16" (25 & 50 cm)

Height: 53 9/16" (136 cm)

Weight:

3.3 lbs. (1.5 kg)

Accessories:

Spotlight, Transport Case, Graphic Panel



Attract extra attention to your literature with the two pocket Expand BrochureHolder with a graphic panel (shown on the left). All stands hold 8 1/2" x 11" literature.

Expand Spotlights

Highlight any message

Add a spotlight to a display to enhance the impact and color of any graphic. We offer both halogen and LED spotlights. Our LED lights have a life expectancy of 50,000 hours (halogen: 2,000 hours); both are cost-effective and environmentally friendly.

For our pop ups walls

Expand Spotlight (LED)

- Environmentally friendly & cost-effective - long life expectancy & energy efficient (19 W)
- Complies with all CE, UL and CSA requirements
- Delivered in a nylon bag

Expand Spotlight (200W)

- Halogen
- Safety certified
- Delivered in a nylon bag



For our retractable, non-retractable displays & Expand BrochureHolder

Expand Spotlight (50W)

- Halogen
- Safety certified
- Delivered in a hardcase





Outdoor Products

Durable displays for outdoor events, campaigns, or point of sale activity

All of our outdoor products have gone through a rigorous development and testing process to handle wear and tear by weather and wind.

All outdoor products are portable, and come in a bag for easy transport.

Expand FlagStand XL

Extra tall and stable flag display for outdoor use

The Expand FlagStand XL is a stable, portable flag display with a telescopic pole, making it possible to raise the height to a soaring 18 feet (5.5 m). The simple construction and very few loose parts allows for simple transport, and makes this product a trouble-free set up.

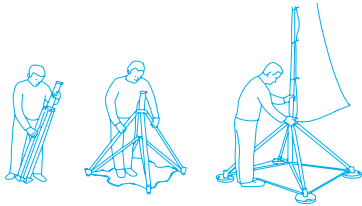

The Expand FlagStand XL comes in two versions: with weighted plates or with water bags.



Sizes:

Width: 47 1/4" (120 cm)
Graphic Height: 126" -180" (320-457 cm)
Overall Height: 18' (550 cm)
Footprint: 53 9/16" wide x 59 9/16" deep (with weights)
47 1/4" wide x 47 1/4" deep (with water bags)

Weight:

110 lbs. (50 kg) with weights
203 lbs. (92 kg) with filled water bags



Expand FlagStand 1

A portable flag stand for outdoor use

The Expand FlagStand 1 is a lightweight, portable flag stand perfect for all outdoor events, marketing activities and campaigns.

This flag holder is very stable, even in strong winds, and is available with either an X base or ground stake. It is also available in three different sizes. Whatever Logos, images, or text is featured on the flag will have exceptional visibility.

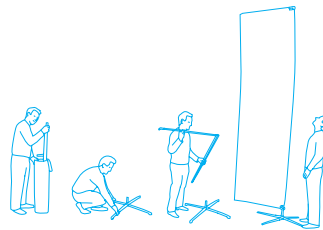

Sizes:

Width: 39 3/8" (100 cm)
 Product Height: 82 11/16", 122 1/16"
 & 161 7/16" (210, 310 & 410 cm)

Weight:

4.4 lbs. (2 kg) with Ground Stake
 17.6 lbs. (8 kg) with Weighted X Base
 14.3 lbs. (6.5 kg) Additional Weight for X Base

Accessories:

Transport Case, Soft Surface Stakes

Choose from a weighted X base or ground stake. An additional weight or soft surface stakes are also available for extra stability.



The flag can be designed in various shapes and sizes.





Expand MediaScreen 2 outdoor

The portable retractable display for outdoor use

This double-sided display is equipped with support feet, and a flexible support pole to guarantee stability even in strong winds. It is designed to resist the wear and tear caused by weather and wind. It can be used on almost any flat surface such as: sand, snow, grass, asphalt, or concrete.

Expand MediaScreen 2 outdoor has a patented solution and is the perfect display for most outdoor events and brand activations.

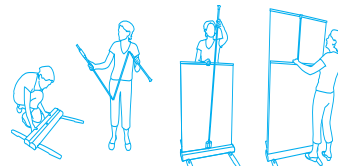

Size:

Width: 33 7/16" (85 cm)
Height: 70 7/8" (180 cm)

Weight:

31 lbs. (14 kg) Including Bags

Accessories:

Transport Case, Soft Surface Stakes





Expand DisplayTunnel

Designed to look and perform like nothing else on the market.

The Expand DisplayTunnel is a clever and ingenious way of showing a logo or message at outdoor events. Use this portable display at any event where a sponsor logo needs to be displayed such as: sporting events, car races, marketing campaigns, and product launches. It is durable enough to be used in most outdoor environments.

This weatherproof display offers a unique spring construction which allows the product to virtually unfold itself once you take it out of the bag. When the event is over, simply collapse the unit and place it into the bag.

Sizes:

Width: 24 7/16" (62 cm)

Height: 22 13/16" (58 cm)

Length: 78 3/4" (200 cm)

Weight:

15.8 lbs. (6.8 kg)

Including Bag

All you need to do is open the bag. The Expand DisplayTunnel does the rest by itself in seconds!



www.bciimage.com

866 971-1008



10'x10'

Expand VenueTent

Place your brand above the crowd

The Expand VenueTent is the perfect accessory to enhance any brand at any marketing event. Display your logo or message high above the crowd, and create a shaded spot for customers and staff.

The aluminum frame is lightweight and extremely durable and can be set up in few minutes. There are a variety of accessories including: ground stakes for soft surfaces or weighted plates for pavement and concrete. Add a back wall and side skirts to provide additional locations for logos and branding.



Easily set up and adjust the height of the tent with spring loaded locking levers.

Sizes:

10'x10' & 20'x 10'

Weight:

44 & 88 lbs. Including Bag with Wheels

Accessories:

Weights, Ground Stakes, Side Walls, Back Wall, Shipping Case



20'x10'



www.bciimage.com

866 971-1008

What about the artwork?

To get the most out of your message, please review this useful advice for designing your artwork:

Place the logo at the top to make sure it is visible from a distance. Also remember to place your message where it is visible.

Put some time into the copy text and try to keep it short. In most cases, you only have a few seconds to catch the attention of your audience.

Choose a font that is easy to read and a font size that is suitable for the reading distance.

Avoid too much text and images as it easily results in a design that is too busy, and your audience may miss your message completely.

Please find artwork templates for all of our products as well as technical guidelines on www.expandmedia.com.

Plan your events in our free 3D tool - Expand DisplayBuilder



What will my event or marketing activation look like? With our 3D design tool you will quickly see how much you can fit into your floor space and how it will look. First, choose your floor size. Then drag and drop your product selections. You can even upload your own jpeg files to view on your display choices.

Go to www.expandmedia.com to use our free 3D tool.

